

Parcel 3 - Soil Map

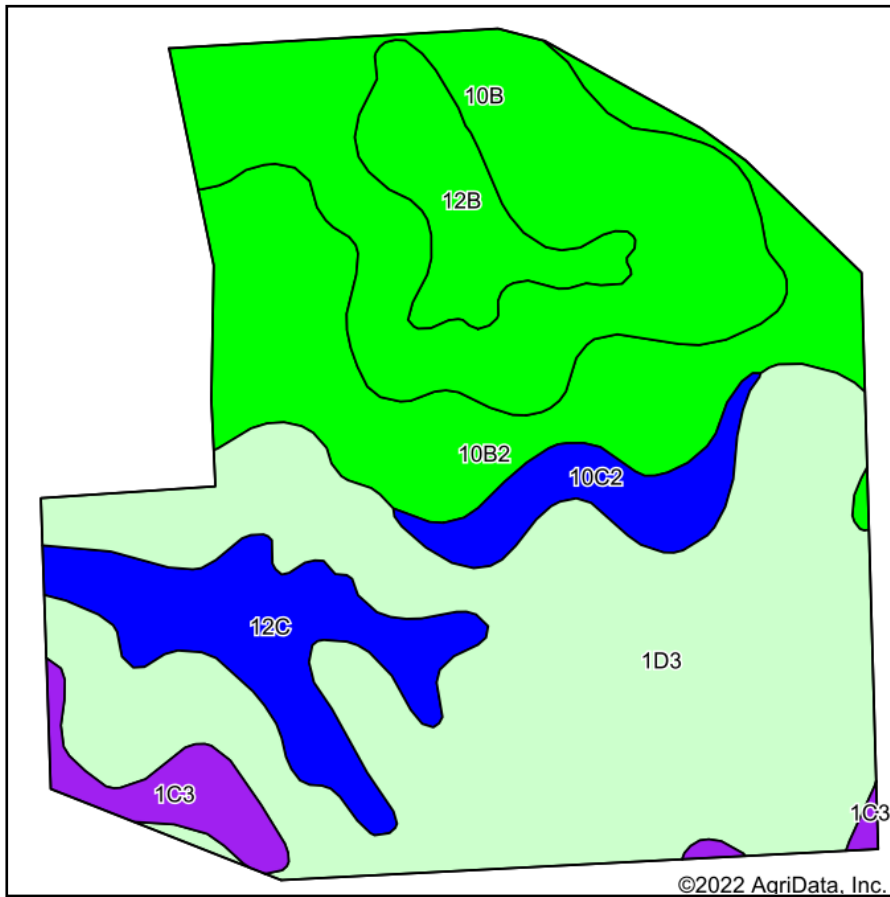

Soils data provided by USDA and NRCS.

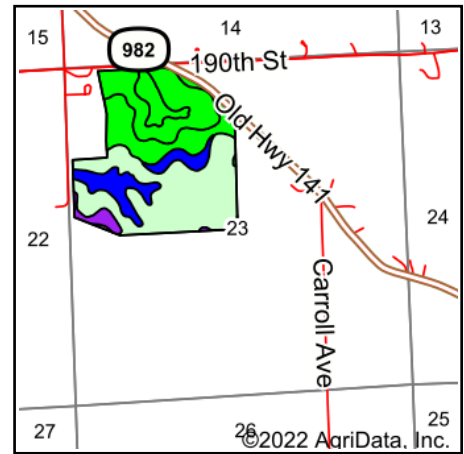

State: **Iowa**
 County: **Woodbury**
 Location: **23-88N-47W**
 Township: **Woodbury**
 Acres: **126.5**
 Date: **2/10/2022**

Stalcup
 Ag Service

Maps Provided By:
surety
 CUSTOMIZED ONLINE MAPPING
 © AgriData, Inc. 2021 www.AgriDataInc.com



Area Symbol: IA193, Soil Area Version: 31

Code	Soil Description	Acres	Percent of field	CSR2 Legend	Non-Irr Class *c	*i Corn Bu	*i Soybeans Bu	CSR2**	CSR
1D3	Ida silt loam, 9 to 14 percent slopes, severely eroded	54.58	43.1%		IIIe	126.4	36.7	32	37
10B	Monona silt loam, 2 to 5 percent slopes	25.36	20.0%		Ile	232	67.3	95	74
10B2	Monona silt loam, 2 to 5 percent slopes, eroded	21.00	16.6%		Ile	227.2	65.9	91	72
12C	Napier silt loam, 5 to 9 percent slopes	10.22	8.1%		IIIe	214.4	62.2	89	58
12B	Napier silt loam, 2 to 5 percent slopes	6.78	5.4%		Ile	230.4	66.8	93	72
10C2	Monona silt loam, 5 to 9 percent slopes, eroded	4.88	3.9%		IIIe	211.2	61.2	86	57
1C3	Ida silt loam, 5 to 9 percent slopes, severely eroded	3.68	2.9%		IIIe	156.8	45.5	58	46
Weighted Average					2.58	181.1	52.6	65.1	54.8

**IA has updated the CSR values for each county to CSR2.

*i Yield data provided by the ISPAID Database version 8.1.1 developed by IA State University.

*c: Using Capabilities Class Dominant Condition Aggregation Method

Soils data provided by USDA and NRCS.