

# Parcel 1 - Soil Map

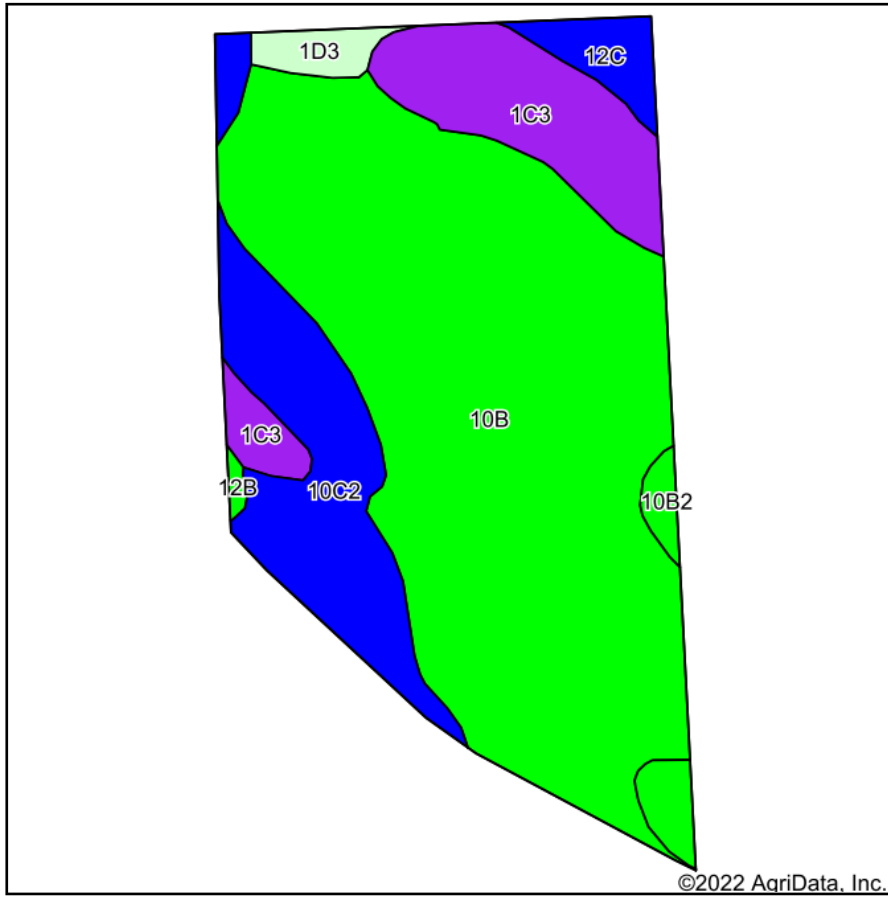

Soils data provided by USDA and NRCS.

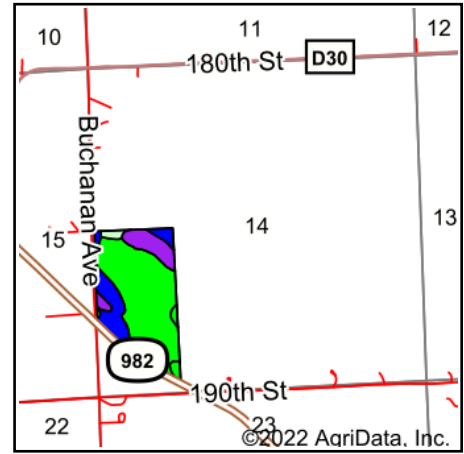

State: **Iowa**  
 County: **Woodbury**  
 Location: **14-88N-47W**  
 Township: **Woodbury**  
 Acres: **60.06**  
 Date: **2/11/2022**



Area Symbol: IA193, Soil Area Version: 31

Code	Soil Description	Acres	Percent of field	CSR2 Legend	Non-Irr Class *c	*i Corn Bu	*i Soybeans Bu	CSR2**	CSR
10B	Monona silt loam, 2 to 5 percent slopes	39.76	66.2%		Ile	232	67.3	95	74
10C2	Monona silt loam, 5 to 9 percent slopes, eroded	8.96	14.9%		IIle	211.2	61.2	86	57
1C3	Ida silt loam, 5 to 9 percent slopes, severely eroded	7.11	11.8%		IIle	156.8	45.5	58	46
12C	Napier silt loam, 5 to 9 percent slopes	1.56	2.6%		IIle	214.4	62.2	89	58
10B2	Monona silt loam, 2 to 5 percent slopes, eroded	1.43	2.4%		Ile	227.2	65.9	91	72
1D3	Ida silt loam, 9 to 14 percent slopes, severely eroded	1.06	1.8%		IIle	126.4	36.7	32	37
12B	Napier silt loam, 2 to 5 percent slopes	0.18	0.3%		Ile	230.4	66.8	93	72
Weighted Average					2.31	217.6	63.1	87.9	67

\*\*IA has updated the CSR values for each county to CSR2.

\*i Yield data provided by the ISPAID Database version 8.1.1 developed by IA State University.

\*c: Using Capabilities Class Dominant Condition Aggregation Method

Soils data provided by USDA and NRCS.