

# Soils Map - Tract 1

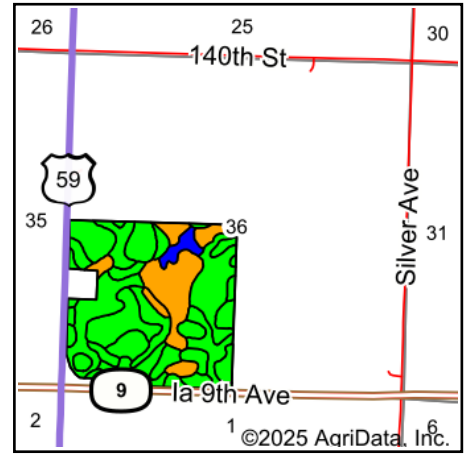

State: **Iowa**  
 County: **Osceola**  
 Location: **36-100N-41W**  
 Township: **Wilson**  
 Acres: **144.98**  
 Date: **9/3/2025**

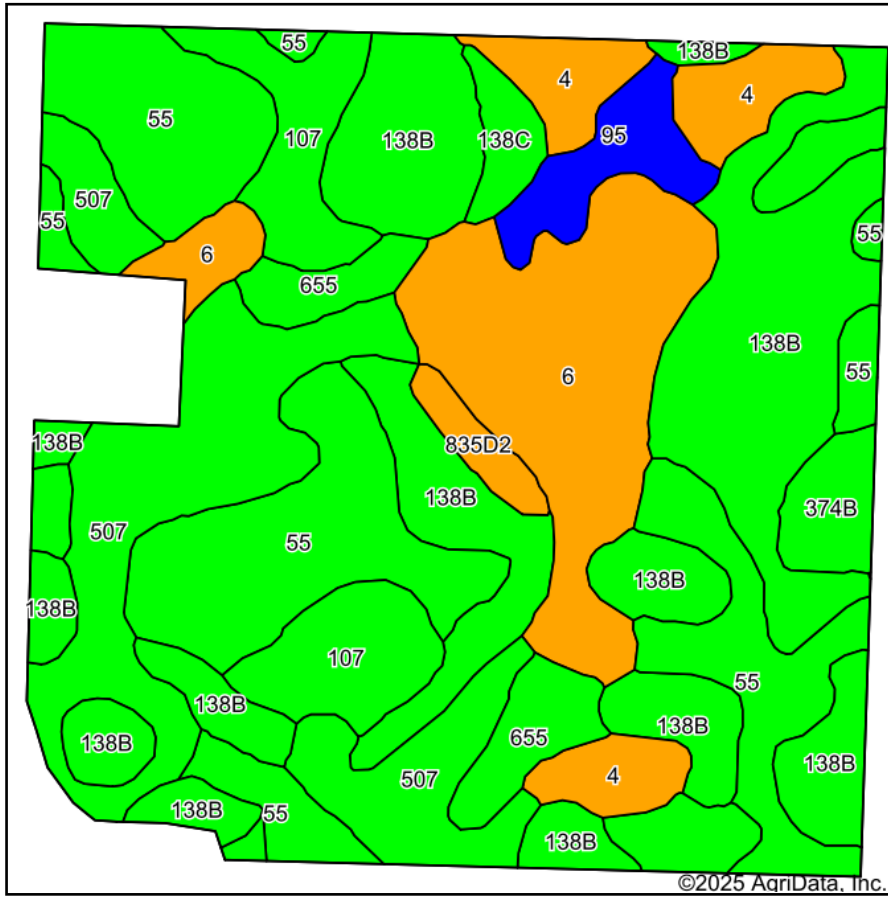

Maps Provided By:  
**surety**  
 CUSTOMIZED ONLINE MAPPING  
 © AgriData, Inc. 2023 www.AgriDataInc.com



Area Symbol: IA143, Soil Area Version: 35

Code	Soil Description	Acres	Percent of field	CSR2 Legend	Non-Irr Class *c	*i Corn Bu	*i Soybeans Bu	*i Water-Holding Inch	CSR2**	CSR
138B	Clarion loam, 2 to 6 percent slopes	40.90	28.2%		Ile	225.6	65.4	11.3	89	73
55	Nicollet clay loam, 1 to 3 percent slopes	32.02	22.1%		Iw	233.6	67.7	10.5	89	73
507	Canisteo clay loam, 0 to 2 percent slopes	23.19	16.0%		Ilw	224.0	65.0	10.0	84	71
6	Okoboji silty clay loam, 0 to 1 percent slopes	18.10	12.5%		Illw	177.6	51.5	11.7	58	43
107	Webster clay loam, 0 to 2 percent slopes	9.25	6.4%		Ilw	224.0	65.0	11.0	86	70
4	Knoke silty clay loam, 0 to 1 percent slopes	7.32	5.0%		Illw	177.6	51.5	11.6	56	41
655	Crippin loam, 1 to 3 percent slopes	4.75	3.3%		Ie	233.6	67.7	11.3	91	71
95	Harps clay loam, 0 to 2 percent slopes	3.72	2.6%		Ilw	198.4	57.5	11.1	72	57
374B	Okabena silty clay loam, 1 to 5 percent slopes	2.48	1.7%		Iw	80.0	23.2	0.0	91	73
138C	Clarion loam, 6 to 10 percent slopes	1.76	1.2%		Ille	209.6	60.8	11.3	84	67
835D2	Omsrud-Storden complex, 10 to 16 percent slopes, moderately eroded	1.49	1.0%		IVe	80.0	23.2	0.0	53	35
Weighted Average					1.94	214	62	10.6	81.7	66.2

\*\*IA has updated the CSR values for each county to CSR2.

\*i Yield data provided by the ISPAID Database version 8.1.1 developed by IA State University.

\*c: Using Capabilities Class Dominant Condition Aggregation Method